

PLAN SHOWING THE EXISTING BUILDING FOR ACCOMMODATION TO RUN SRI VENKATESWARA COLLEGE OF EDUCATION (B.ed) & SRI VENKATESWARA ELEMENTARY TEACHER TRAINING INSTITUTE (D.ed) BEARING D.No.5-195, IN WARD No.5, GAYATRI NAGAR, IN KADIRI MUNICIPALITY, KADIRI.

BY: SREE BALAJI EDUCATIONAL SOCIETY.

TOTAL BUILTUP AREA IN SQ.M : 3071.34
 TOTAL BUILTUP AREA FOR B ED COLLEGE IN SQ.M : 1535.17
 TOTAL BUILTUP AREA FOR D ED COLLEGE IN SQ.M : 1535.17

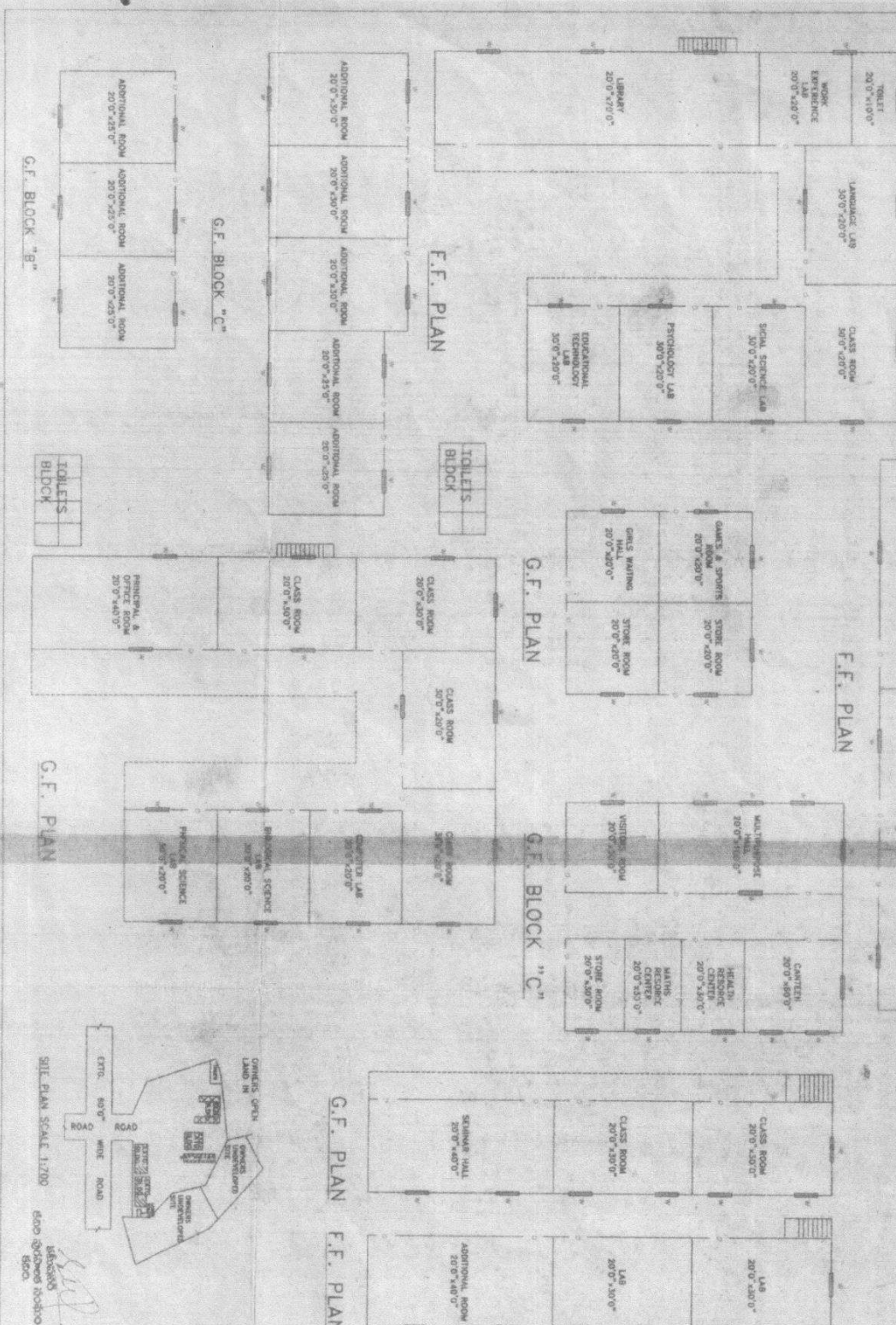

AREAS

□ CARPET AREA OF	
BLOCK 'A' G.F. AREA :	1500.00 SH
BLOCK 'B' G.F. AREA :	2800.00 SH
G.F. AREA :	8600.00 SH
F.F. AREA :	9000.00 SH
BLOCK 'C' G.F. AREA :	6000.00 SH
TOTALS BLOCK AREA :	8000.00 SH
COMMON AREA :	3960.00 SH
STAIRCASE AREA :	400.00 SH
TOTAL AREA :	33,060.00 SH

REFERENCE

DOOR	D	1.00 x 2.10
DOOR	D1	0.75 x 1.80
WINDOW	W	1.50 x 1.50
VENTILATOR	V	0.75 x 0.45
VENTILATOR	V	1.22 x 0.60

APPLICANT (S)
 MUNICIPAL STAN GOVT. Degree College
 KADRI, Kadiri (D.K.)

M.S./ENGINEER
 M. S. / ENGINEER

CLASSIC
 CIVIL CONSULTANTS & CONSTRUCTIONS,
 1st FLOOR, WOODLAND'S BUILDING,
 Opp. L.K.P., SUBHASH ROAD, ANANTAPUR.

NOTE :
 1. ALL DIMENSIONS ARE IN METRES
 2. SCALE 1: 200